

What you will need:

Water Butt with Stand	Measuring tape	Power drill
Hole saw bit	Spirit level	Hacksaw
Screwdriver	Pencil	

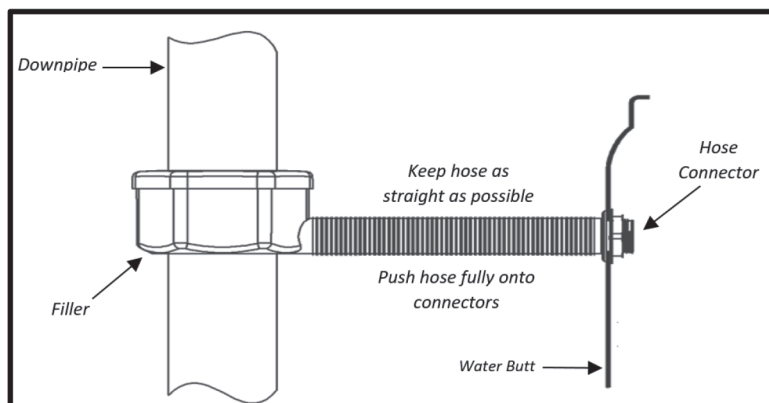
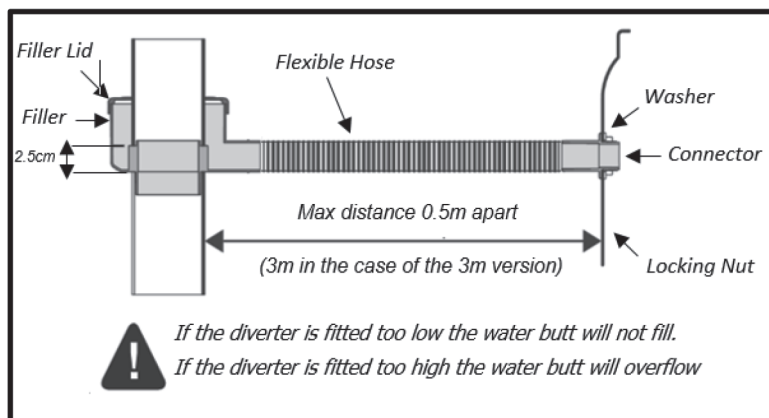
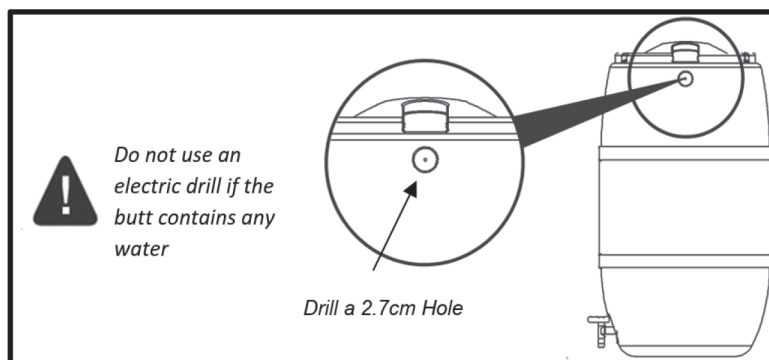

Level the Butt & Drill Hole:

- Select a downpipe that is in a suitable location. The effectiveness of your water butt may be improved by linking it to a pipe that relieves several gutters of rainwater.
- Position the butt adjacent to the selected downpipe on a firm stable base, No more than either 0.5m/ 3m away from the selected rainwater downpipe.
- Select the side of the water butt closest to the downpipe and drill a suitably sized hole in this side (2.7cm diameter), 12.5cm from the top of water butt in the cut away shown.

Cut the Downpipe:

- Mark the level of the bottom of the hose connector on the downpipe.
- Measure about 2.5 cm above this position on the downpipe and mark it again.
- Use your hacksaw to cut the downpipe at these two marks to remove a 2.5cm section.

Attach the Filler:

- Insert the rainwater filler in place of the removed section of downpipe.
- Slide the filler lid onto the top section of the down pipe and push it up out of the way.
- Place the filler base on the lower part of the downpipe so it sits in the gap created.
- Slide the top section back down so that it can be clipped into the base.

Attach the Flexible Hose:

- Secure the flexible hose through the drilled hole.
- Attach the flexible hose from the filler kit to both connections in the downpipe and the water butt respectively.

* Not Suitable for Cast Iron Downpipes

* Water left in water butts in freezing conditions may cause damage

Water butt stand assembly instructions

3 Piece stand

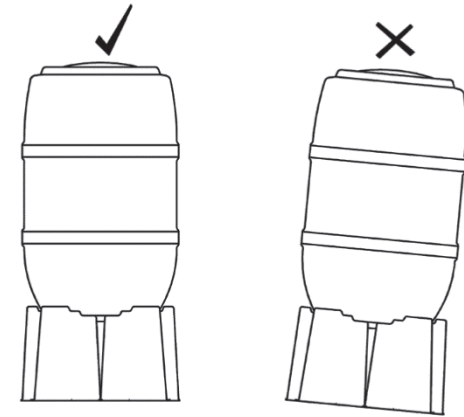

Always place on
FIRM LEVEL BASE

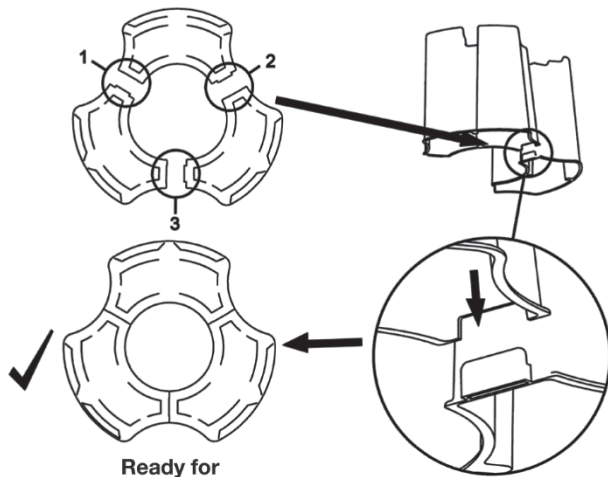

Ready for
water butt

4 Piece stand

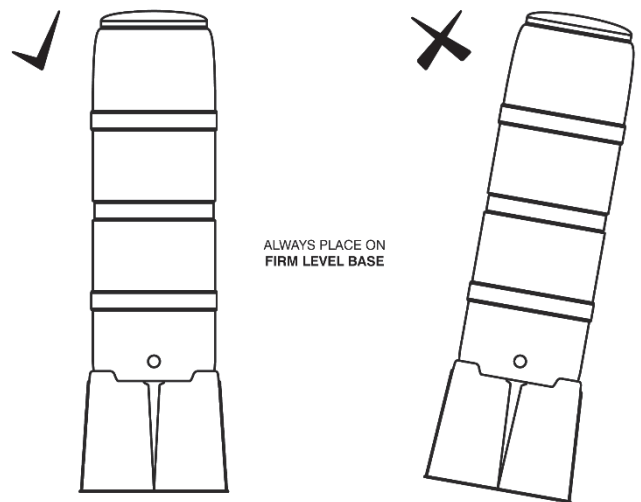

ALWAYS PLACE ON
FIRM LEVEL BASE

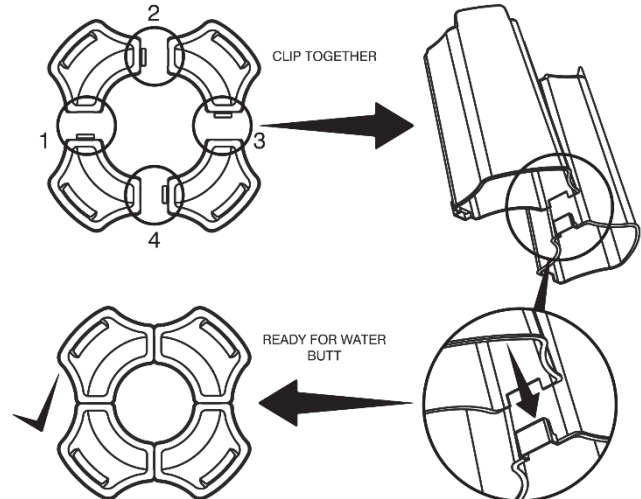

READY FOR WATER
BUTT