

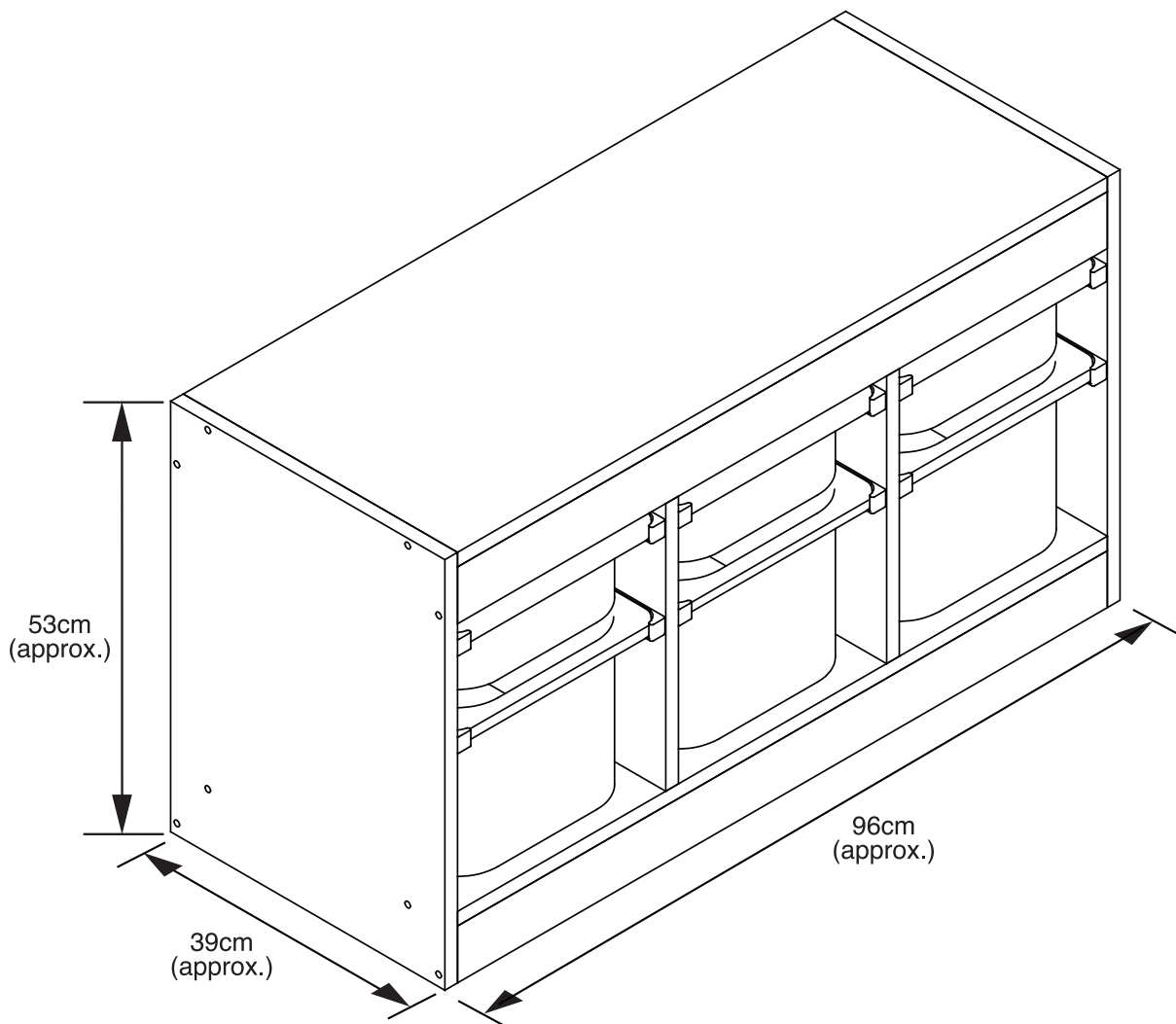

# 6 Basket Storage

Item Code: 404398

## Assembly Instructions



**MAX. LOADING: 34KG ( TOP: 10KG, SMALL BASKETS: 3KG EACH, LARGE BASKETS: 5KG EACH )**

## **SAFETY INFORMATION**

### **Top Tips Before You Start**

- Please check that all parts are present before you start the assembly of your furniture.
- Assess the suitability of the wall or ceiling to ensure that the fastening devices will withstand the forces generated.
- For ease and speed of assembly, we recommend that before you commence each step of the assembly, that you identify all the parts required for that step.
- Please ensure that you have sufficient space and people to assemble your product safely.
- We recommend that, where possible, all items are assembled near to the area in which they will be placed in use, to avoid moving the product unnecessarily once assembled.
- For the protection of your furniture, we recommend that the product is placed on a protected surface during assembly to prevent any damage.

### **Warnings:**

- Adult assembly is required. The assembly should be checked by an adult before each use.
- Unassembled product contains small parts which may present a choking hazard.
- Children should be kept away from the product during assembly to avoid any possible risk of injury.
- Do not use power tools in the assembly of this product as there is a risk of over - tightening and consequently splitting of the wood.
- This product is not suitable for children under age 3 & recommended for children in the age 3 to 6.
- Do not load more than 34kg ( Top: 10kg, Small Baskets: 3kg each, Large Baskets: 5kg each ) onto product. Otherwise there is a risk of injury and/or damage to the product.
- Adult supervision is required at all times whilst children play with this product.
- Do not use this item if any components are missing or damaged.
- Please remove all packaging and packing tags/wires before presenting to a child.
- Small parts. Choking hazard. Packaging is not a toy.
- The parent should regularly check all fittings and re-tighten as necessary before giving the product to children.
- Always place the product on flat, steady and stable surface to prevent tipped over.
- Do not stand or sit on the product. Do not use the product as a stepladder.
- This product is intended for indoor, household use only as it is non industrial product.

### **Care and Maintenance of Your Furniture:**

- Surface wipe only.
- To clean your item, please use a damp cloth and wipe clean. Dry naturally.
- Do not place hot items (e.g. hot drink) directly on the surface.
- Do not use cleaning products which contain ammonia, solvents or abrasive material.
- Do not drag and pull your furniture.
- Do not expose the item to extremes of heat and humidity.
- Examine the product regularly for wear before giving to a child.
- Do not let children play with broken furniture to avoid accidental swallowing suffocation.
- Please retain this information for future reference.

# Part List

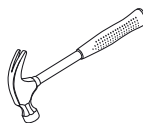
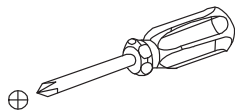

(NOT PROVIDED)

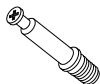

A x 8



B x 8



C x 32



D x 24

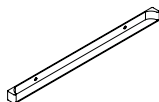

E x 12



F x 20



G x 20

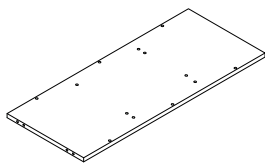
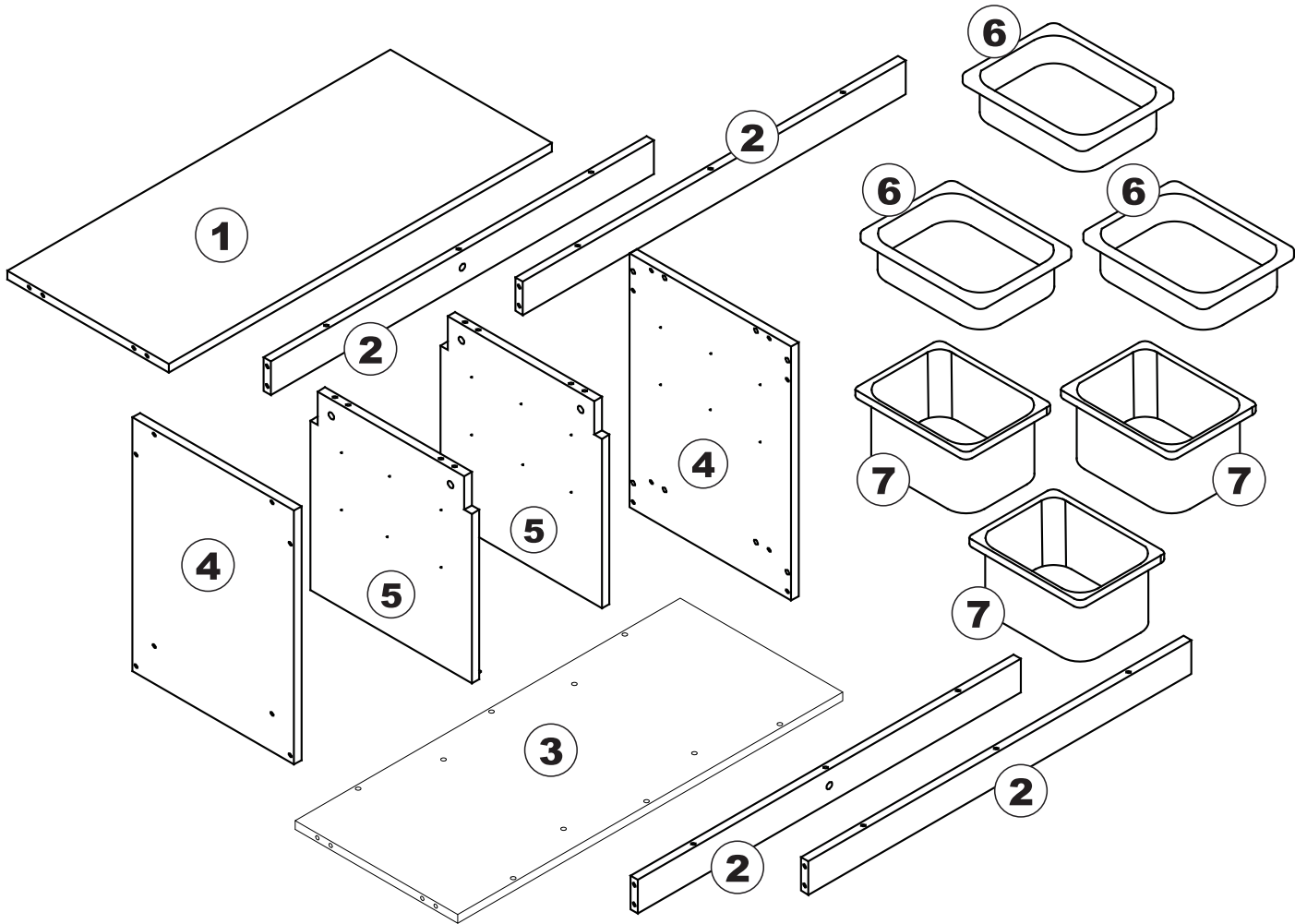

① x2

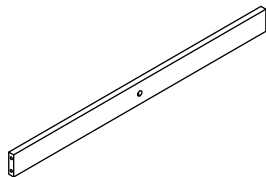

② x4

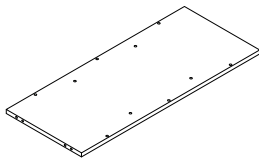

③ x1

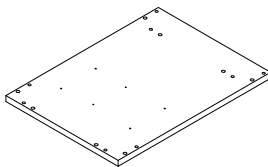

④ x2

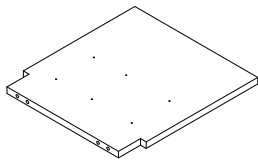

⑤ x2

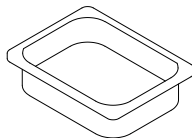

⑥ x3

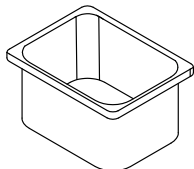

⑦ x3

# SPECIAL TIPS FOR FITTING CAM-LOCKS AND QUICKFIT

## CAM-LOCK

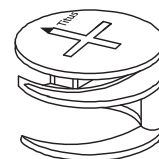

WHEN FITTING CAMLOCK  
ENSURE STARTING POSITION IS CORRECT  
BEFORE YOU INSERT CONNECTING QUICKFIT  
TURN CLOCKWISE UNTIL SECURE

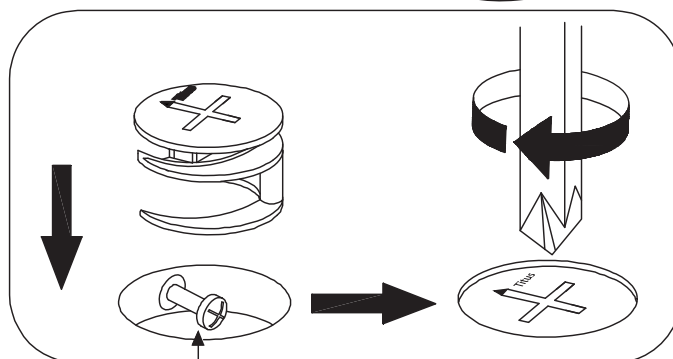
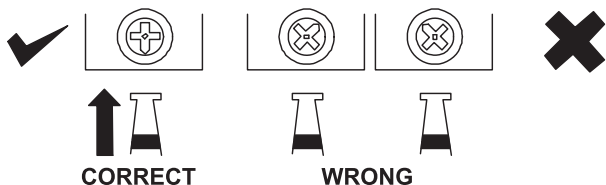

Quickfit head needs to be in centre

## QUICKFIT

Tighten until shoulder is flush with panel. Do not overtighten or leave too loose. (see example below)

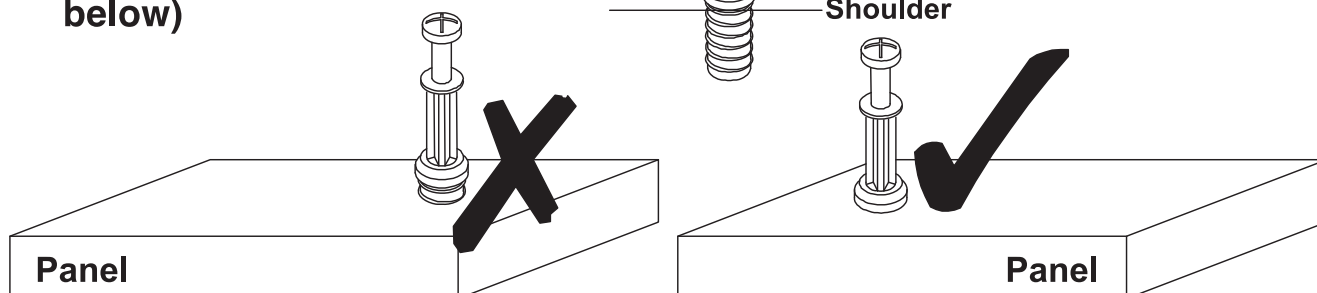

1



A x 8

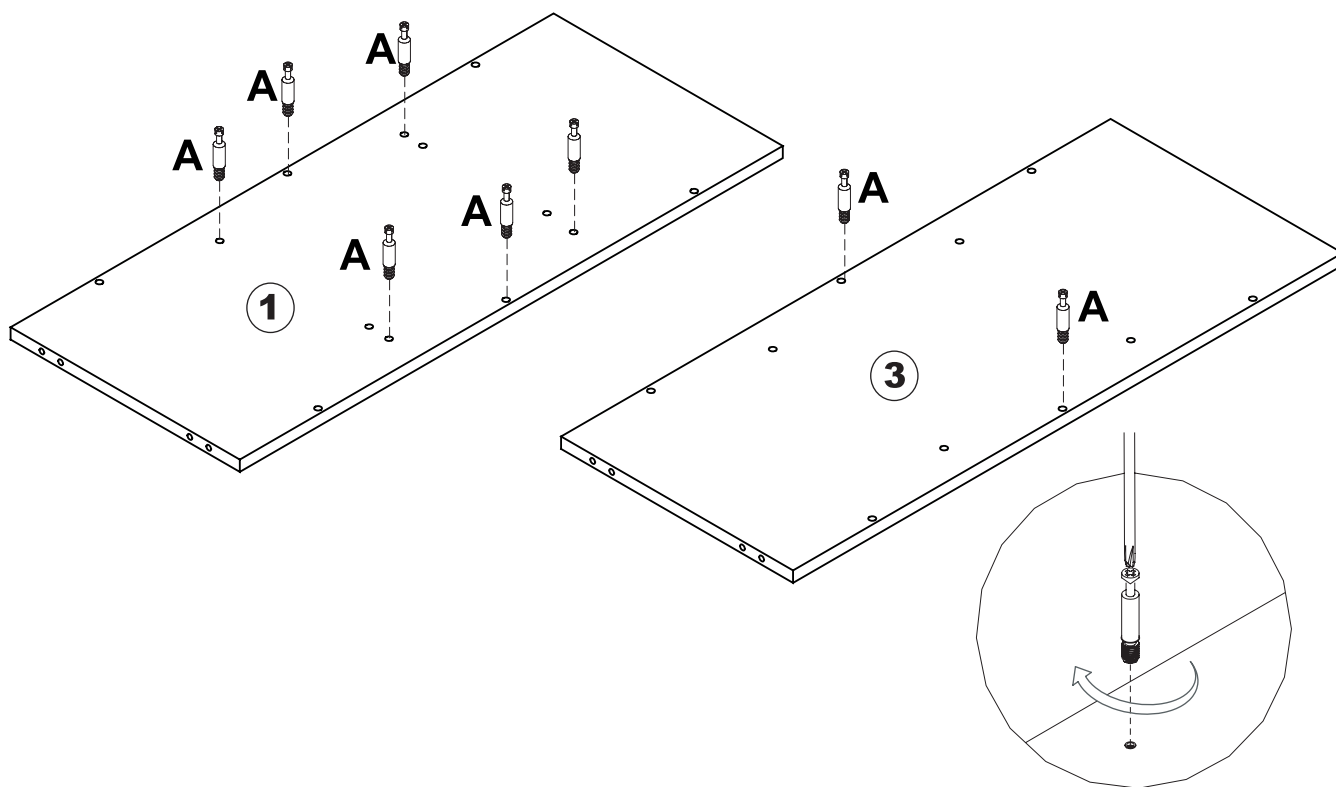

2



B x 2



C x 4

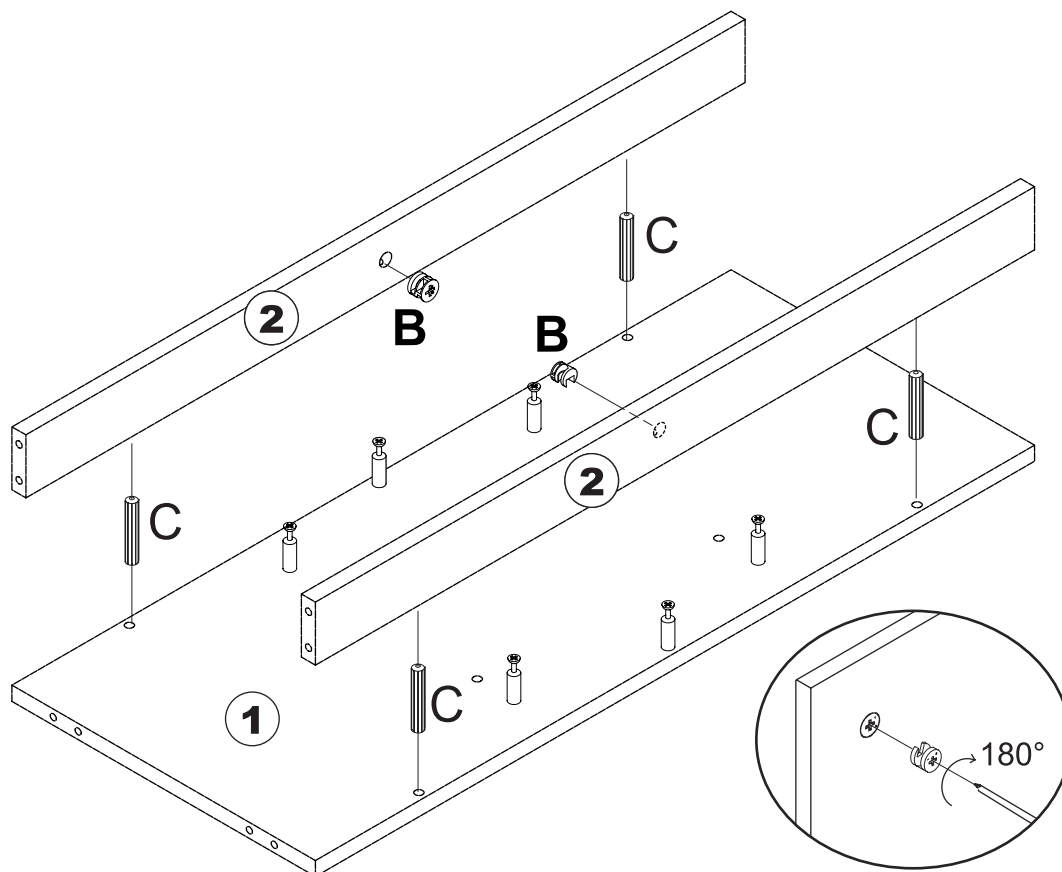

3

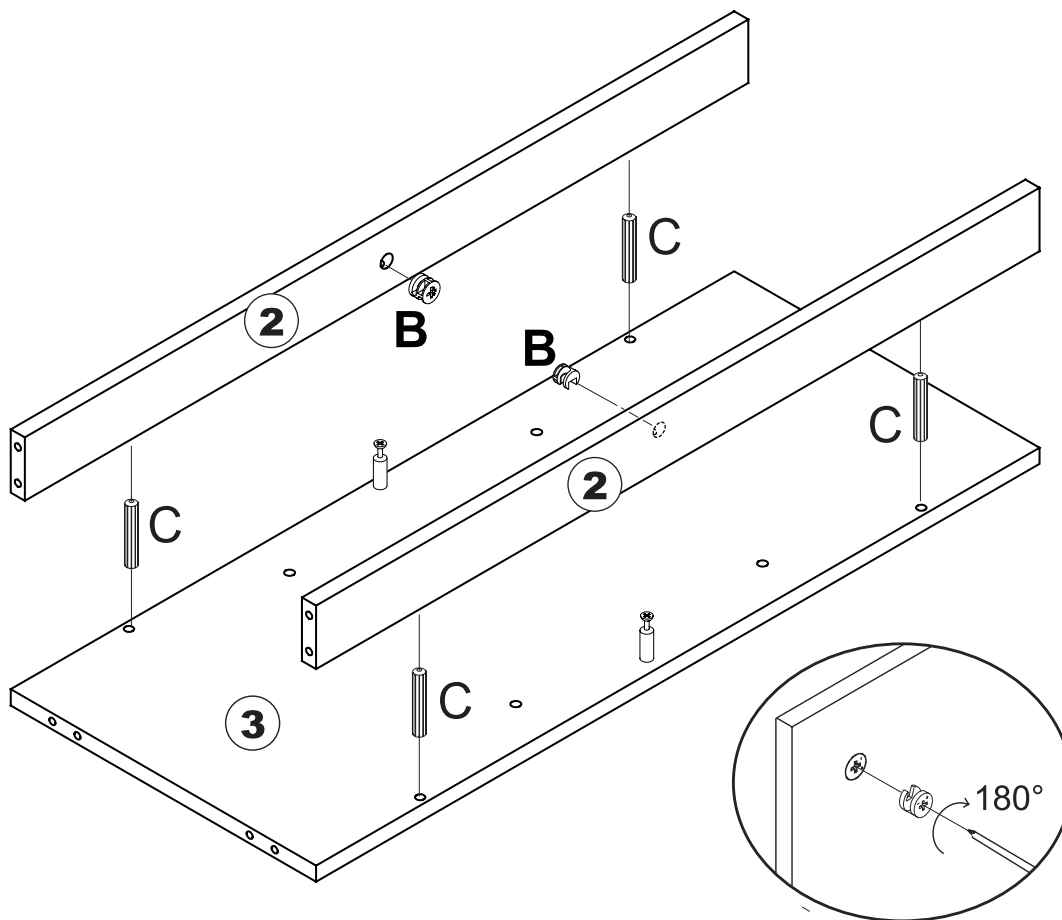

B x 2



C x 4

4

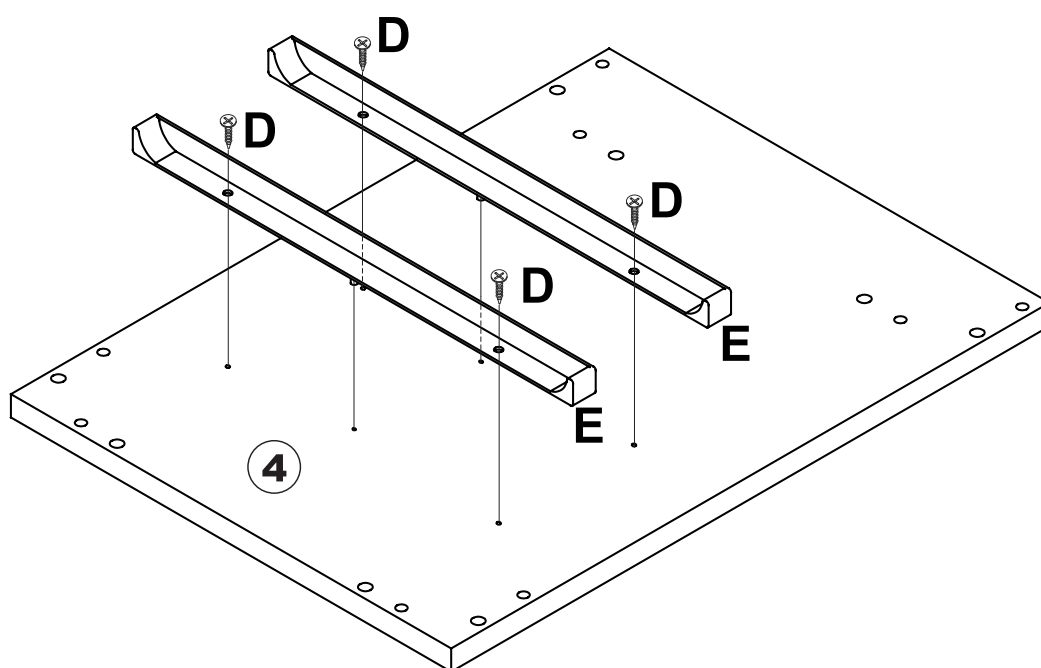

D x 8

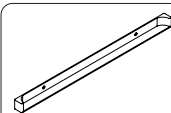

E x 4

X2

5

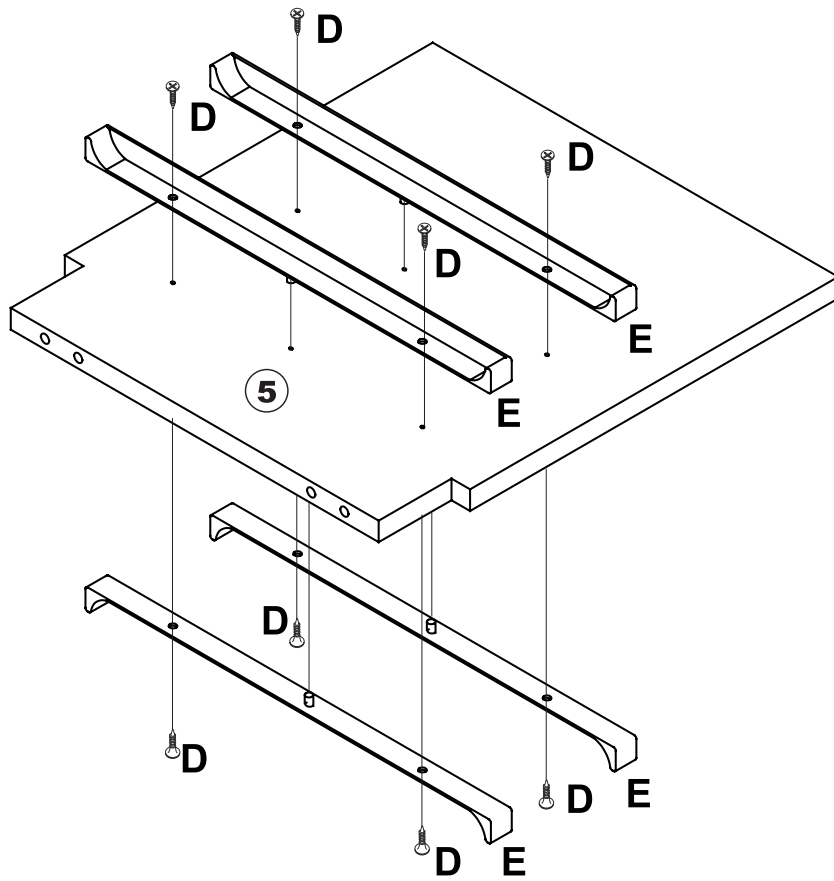

D x 16

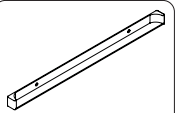

E x 8

X2

6

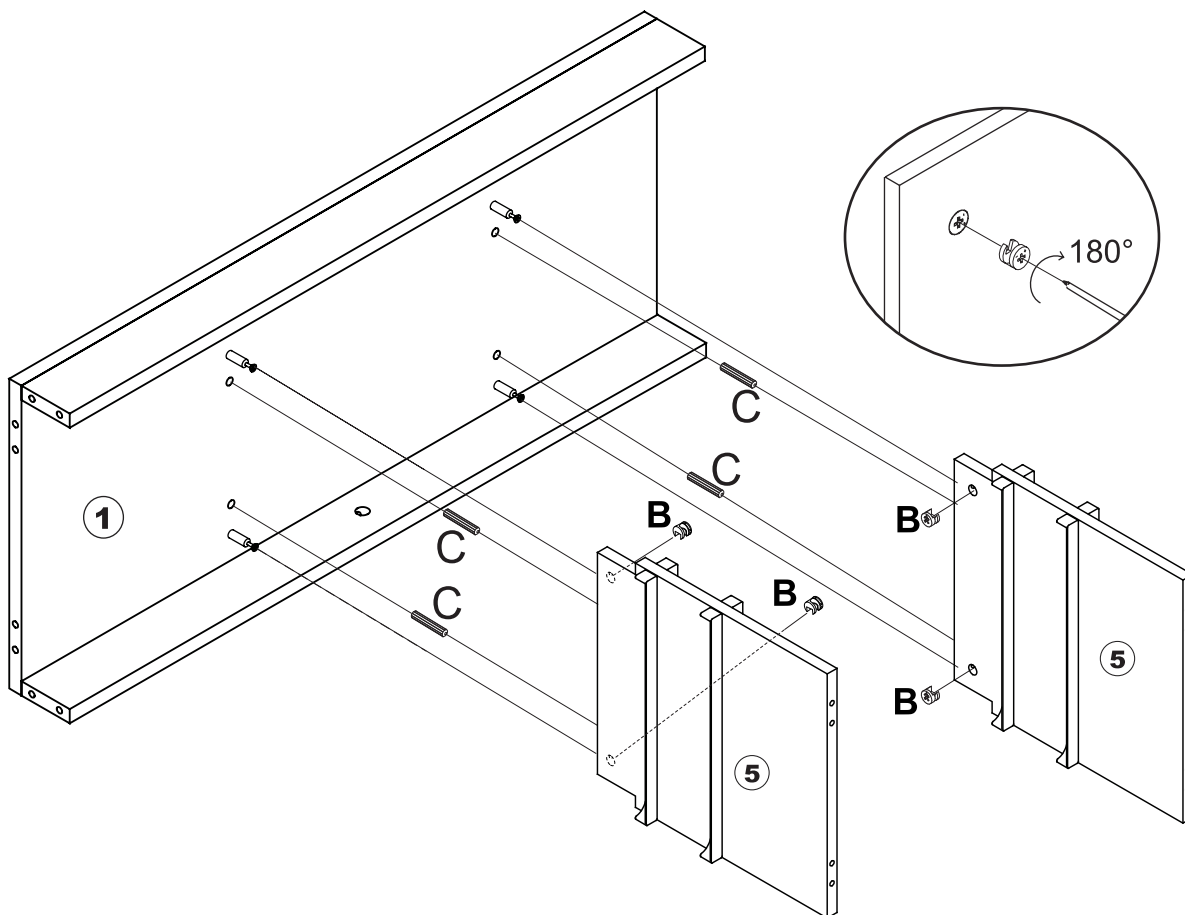

B x 4



C x 4

7

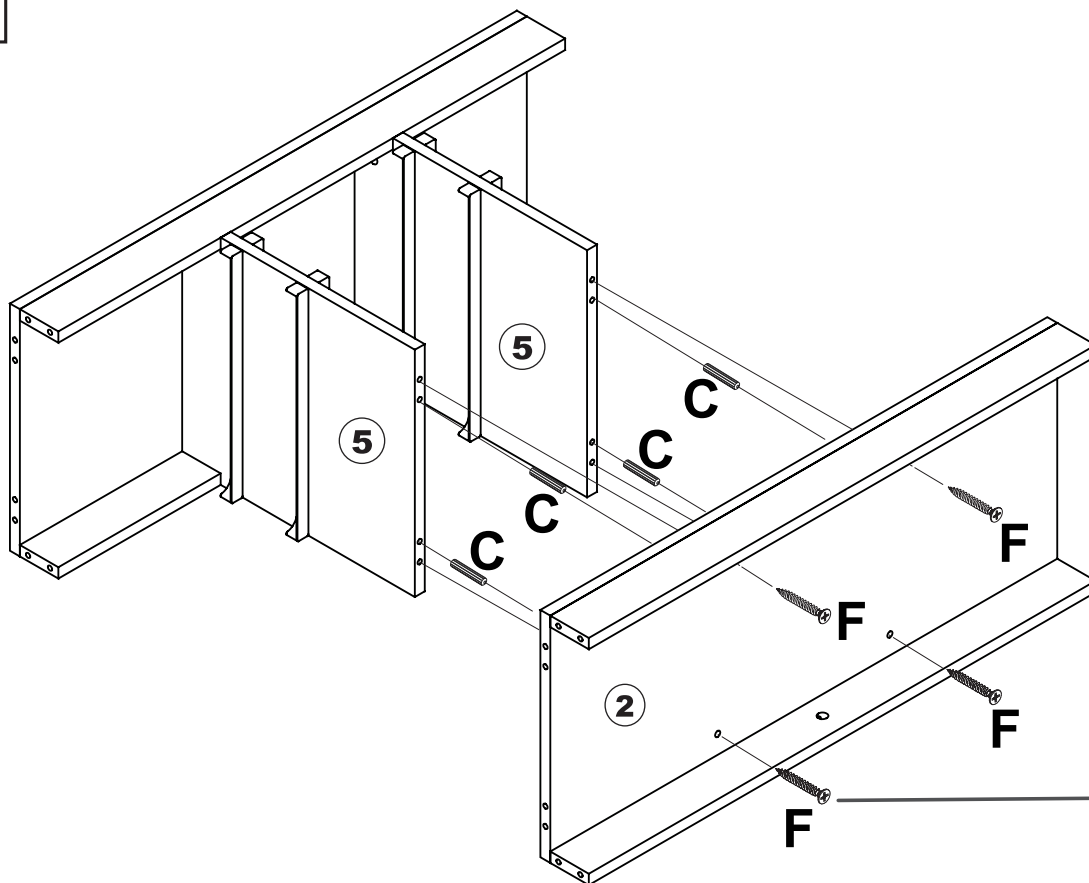

C x 4



F x 4



G x 4

x4

8

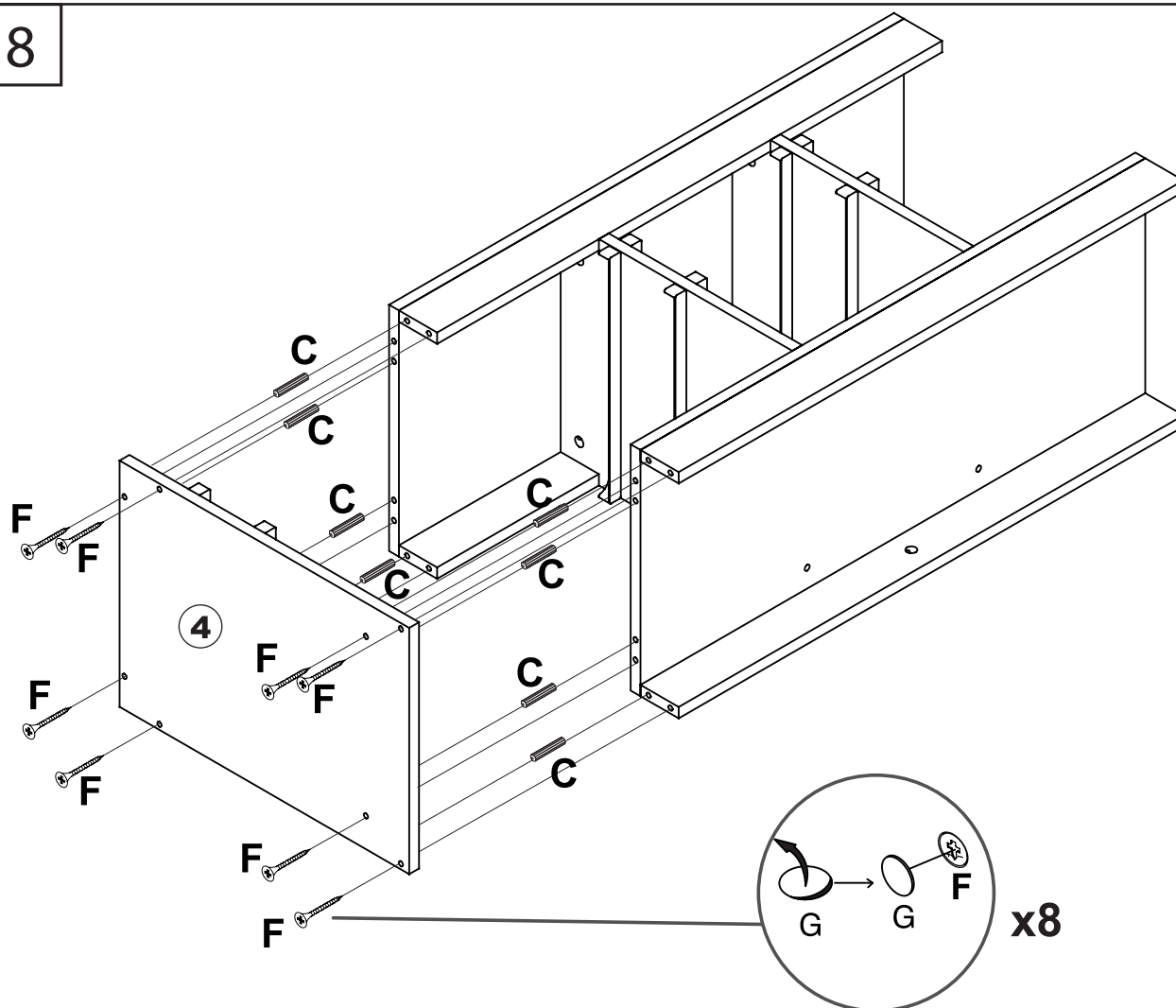

C x 8



F x 8



G x 8

x8



9

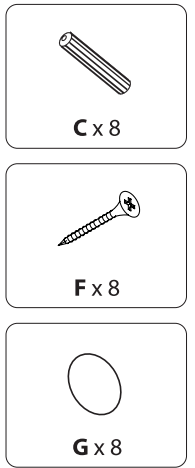
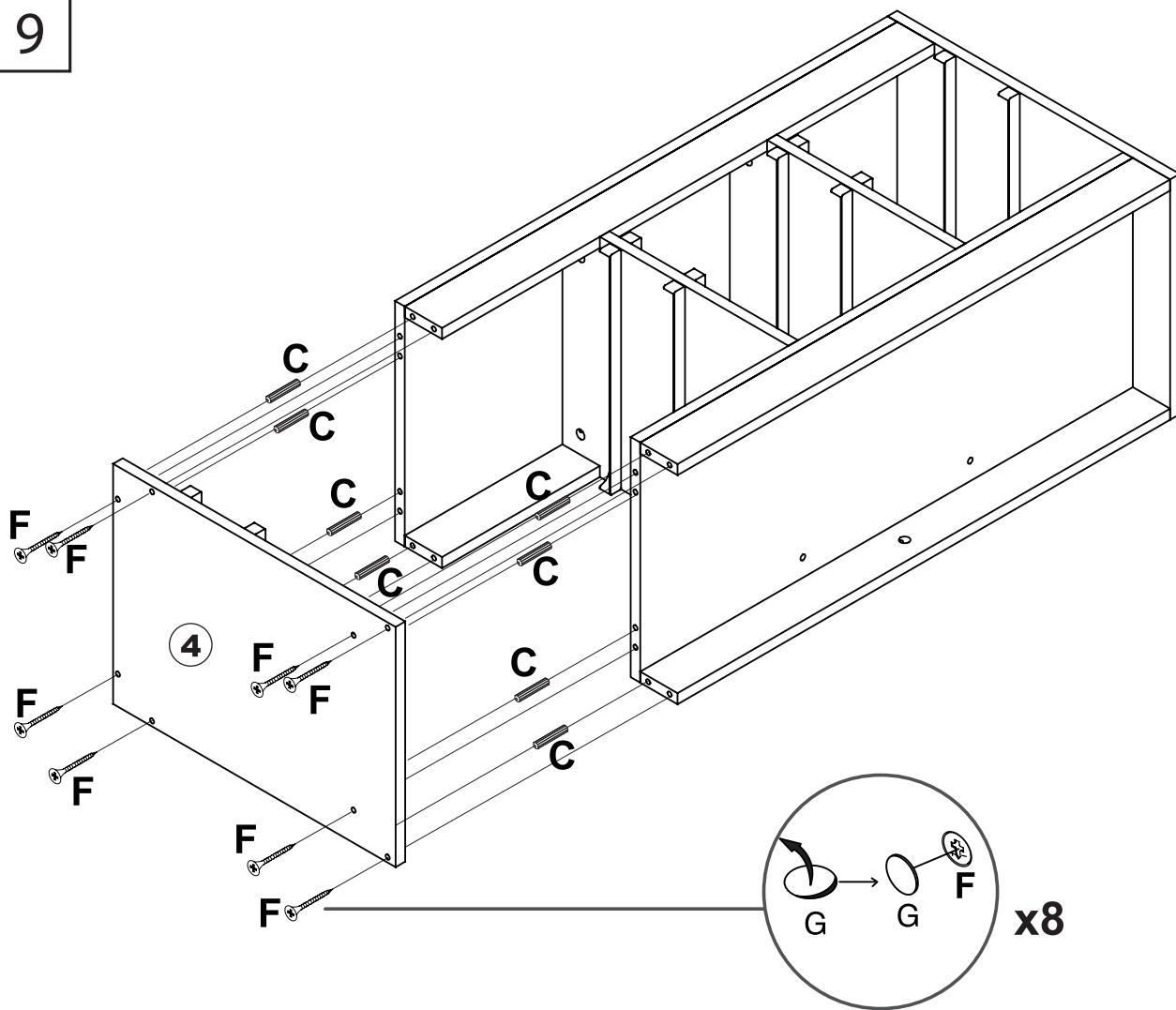

10

